

## REGOLATORI AD INNESTO RAPIDO

PUSH-IN FLOW REGULATORS  
REGULATEURS DE DEBIT INSTANTANES  
DROSSEL MIT STECKANSCHLUSS

## SCHEDA TECNICA SPECIFICATION SHEET - FICHE TECHNIQUE - TECHNISCHES BLATT

### serie METALLO

METAL line  
serie METAL  
METALL-Baureihe

**MATERIALI DI COSTRUZIONE**  
OTTONE (EN 12164-CW614N) NICHELATO  
ZAMAK-15 (UNI 3717) NICHIELATA  
GLIARNIZIONI IN GOMMA ANTIOLEO NBR  
PRESSIONE MAX D'ESERCIZIO: 10 BAR (1 MPa)  
TEMPERATURA DI LAVORO: -10°C (263°K), +80°C (333°K)

**MATERIALS OF CONSTRUCTION**  
NICKEL-PLATED BRASS (EN 12164-CW614N)  
NICKEL-PLATED ZAMAK-15 (UNI 3717)  
OIL-PROOF RUBBER PACKINGS NBR  
MAX WORKING PRESSURE: 10 BAR (1 MPa)  
WORKING TEMPERATURE: -10°C (263°K), +80°C (333°K)

**MATERIEL DE FABRICATION**  
LAITON (EN 12164-CW614N) NICHÉLÉ  
ZAMAK-15 (UNI 3717) NICKÉLÉ  
JOINTS EN CAOUTCHOUC ANTIOUËLE NBR  
PRESSION MAXI D'EXERCICE: 10 BAR (1 MPa)  
TEMPERATURE DE TRAVAIL: -10°C (263°K), +80°C (333°K)

**HERSTELLUNGSMATERIAL**  
MESSING (EN 12164-CW614N), VERNICKELT  
ZAMAK-15 (UNI 3717), VERNICKELT  
DICHTUNGEN NBR, ÖLBESTÄNDIG  
HÖCHSTBETRIEBSDRUCK: 10 BAR (1 MPa)  
BETRIEBSTEMPERATUR: -10°C (263°K), +80°C (333°K)



CORPO PRINCIPALE  
MAIN BODY  
CORPS PRINCIPAL  
KÖRPER

REGISTRO CON SISTEMA DI REGOLAZIONE A LAMINAZIONE  
VIS DE REGLAGE AVEC SYSTEME DE REGULATION A ENLAINTE  
REGISTER WITH REGULATING LAMINATION  
EINSTELLSPINDEL MIT EINSTELLSCHEIBE

CORPO ESTERNO  
OUTER BODY  
CORPS EXTERNE  
AUSSENGEHÄUSE

ATTACCO FILETTATO A RENDITA PORTATA  
FULL CAPACITY THREADED CONNECTOR  
CONNEXION FILETÉE A CAPACITÉ TOTALE  
MIT VOLLDURCHFÄHIGKEIT BELASTETER GEWINDEANSCHLUSS

ANELLO DI SGANCIO  
RELEASE RING  
POUR DÉMONTAGE  
DRUCKRING

A RICHIEDERLA  
UNDER REQUEST  
SUR DEMANDE  
SUF ANFRAGE



REGOLATORE PER CILINDRO  
REGULATOR FOR CYLINDER  
REGULATEUR POUR VERIN  
AUSLUFTRÖSSEL (FÜR ZYLINDER)

REGOLATORE PER VALVOLA  
REGULATOR FOR VALVE  
REGULATEUR POUR VANNE  
ZULUFTTRÖSSEL (FÜR VANTE)

REGOLATORE BIDIREZIONALE  
REGULATOR BIDIRECTIONAL  
REGULATEUR BIDIRECTIONNEL  
BEIDSEITIG WIRKENDE DROSSEL

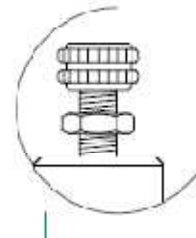

REGISTRO A VOLANTINO  
ADJUSTING KNOB  
VIS DE REGLAGE A BOUTON  
EINSTELLSPINDEL MIT HANDRAD

**O-RING/GUARNIZIONI**  
OIL-PROOF RUBBER  
JOINTS  
DICHTUNGEN

ESSENTE DI SILICONE  
SILICONE FREE  
LIBRES DE SILICONE  
SILIKONFREI



INFORMAZIONI SULLA CODIFICA ARTICOLI: vedi pag 24-25  
INFORMATION ABOUT THE ITEMS CODING: see pages 24-25  
RENSEIGNEMENTS SUR LA CODIFICATION DES ARTICLES: voir aux pages 24-25  
BUSSEL-NUMMERNISYSTEM: siehe Seite 24-25

**SISTEMA DI AGGANCIAMENTO DEL TUBO**  
SYSTEM OF COUPLING OF THE TUBE  
SYSTEME D'ACCROCHAGE DU TUBIF  
SYSTEM VON KUPPLUNG VON DAS ROHR

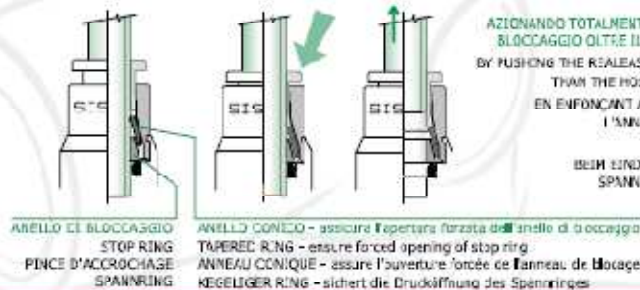

ANELLO DI BLOCCAGGIO  
STOP RING  
PINCE D'ACCROCHAGE  
SPANNRING

ANELLO CONICO - assicura l'apertura forzata dell'anello di bloccaggio  
TAPERED RING - assure forced opening of stop ring  
ANNEAU CONIQUE - assure l'ouverture forcée de l'anneau de blocage  
KEGELIGER RING - sichert die Drucköffnung des Spannringes

AZIONANDO TOTALMENTE L'ANELLO DI SGANCIO, SI COMANDA L'APERTURA DELL'ANELLO DI BLOCCAGGIO OLTR E IL DIAMETRO DEL TUBO, GARANTENDO L'ESTRAZIONE SENZA DANNO.  
BY PUSHING THE RELEASE RING, THE INNER STOP RING EXPANDES TO A DIAMETER GREATER THAN THE HOSE OUT SIDE DIAMETER, ALLOWING EXTRACTION WITHOUT DAMAGE.  
EN ENFONCANT A FOND L'ANNEAU DE DÉMONTAGE, ON COMMANDE L'OUVREURE DE L'ANNEAU DE BLOCCAGE AU DIAMÈTRE DU TUBIF GARANTISSANT L'EXTRACTION SANS DOMMAGE.  
BEIM EINDRÜCKEN DES DRUCKRINGS BIS ZUM ANSCHLAG, ÖFFNET SICH DER SPANNRING UND DAS ROHR KANN SCHADLOS HERAUS GEZÖGEN WERDEN.

**ATTACCO FILETTATO**  
THREADED CONNECTOR  
CONNEXION FILETÉE  
GEWINDEANSCHLUSS

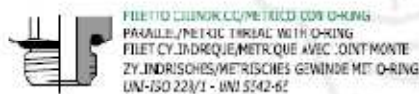

FILETTO CILINDRICO/METRICO CON O-RING  
PARALLEL/METRIC THREAD WITH O-RING  
FILET CYLINDRIQUE/MÉTRIQUE AVEC JOINT-MONTÉ  
ZYLINDRISCHES/METRISCHES GEWINDE MIT O-RING  
UNI-ISO 228/1 - UNI 5542-6/2



FILETTO CONICO CON PTFE  
TAPERED THREAD WITH PTFE  
FILET CONIQUE AVEC TEFLON  
KONISCHES GEWINDE MIT TEFLON  
UNI-ISO 7/1



FILETTO CILINDRICO FEMMINA  
FEMALE PARALLEL THREAD  
FILET CYLINDRIQUE FEMELLE  
ZYLINDRISCHES INWENIGEWINDE  
UNI-ISO 228/1

**TIPPI DI TUBO INNESTABILI**  
TUJES D'ACCOUPLMENT  
SUITABLE FOR SC-LAUCHTYPEN

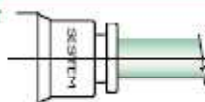

R1/8" (PA11/12), POLIURETANO, POLIETILENE, POLIESTERE, TEFLON, NYLON (PA6): ±0,05 (Ø4-Ø10) - ±0,1 (Ø12-Ø14),  
R1/4" (PA11/12), POLIURETANO, POLIETILENE, POLIESTERE, TEFLON, NYLON (PA6): ±0,05 (Ø4-Ø10) - ±0,1 (Ø12-Ø14),  
R1/2" (PA11/12), POLIURETANO, POLIETILENE, POLIESTERE, TEFLON, NYLON (PA6): ±0,05 (Ø4-Ø10) - ±0,1 (Ø12-Ø14),  
R1/2" (PA11/12), POLIURETANO, POLIETILENE, POLIESTERE, TEFLON, NYLON (PA6): ±0,05 (Ø4-Ø10) - ±0,1 (Ø12-Ø14).

## SR63/C – SR63/V – SR63/B

SR63 MINI REGULADOR CILINDRICO MACHO

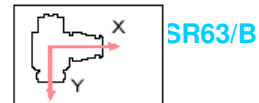
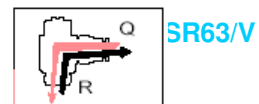
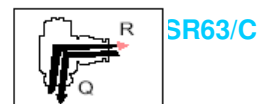
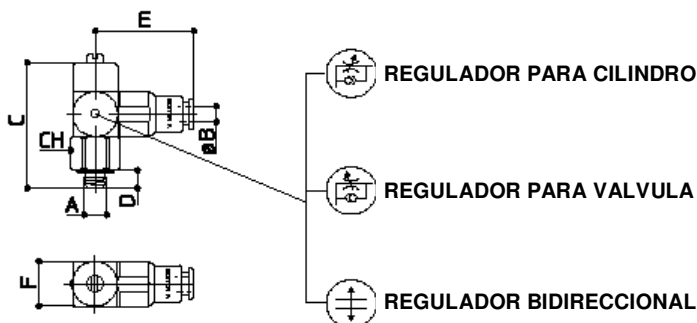

CODIGO	A	B	C	D	E	F	CH	Ø	Q⇒R	R⇒Q	Gr
SR6304M5/C	M5	4	29	4	22,5	10	10	1,2	0-70 NI/min	140 NI/min	19
SR6305M5/C	M5	5	29	4	22,5	10	10	1,2	0-70 NI/min	140 NI/min	19
SR6306M5/C	M5	6	29	4	24	12	10	1,2	0-70 NI/min	140 NI/min	28
SR6304M5/V	M5	4	29	4	22,5	10	10	1,2	0-70 NI/min	140 NI/min	19
SR6305M5/V	M5	5	29	4	22,5	10	10	1,2	0-70 NI/min	140 NI/min	19
SR6306M5/V	M5	6	29	4	24	12	10	1,2	0-70 NI/min	140 NI/min	28
SR6304M5/B	M5	4	29	4	22,5	10	10	1,2	0-70 NI/min	140 NI/min	19
SR6305M5/B	M5	5	29	4	22,5	10	10	1,2	0-70 NI/min	140 NI/min	19
SR6306M5/B	M5	6	29	4	24	12	10	1,2	0-70 NI/min	140 NI/min	28

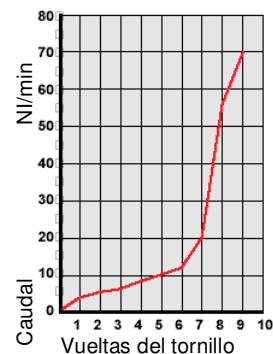

## SR64/C – SR64/V – SR64/B

SR64 MINI REGULADOR CILINDRICO MACHO/HEMBRA

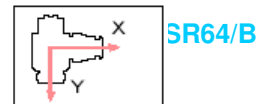
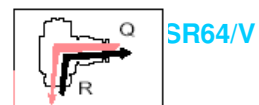
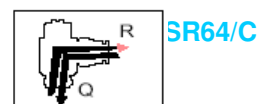
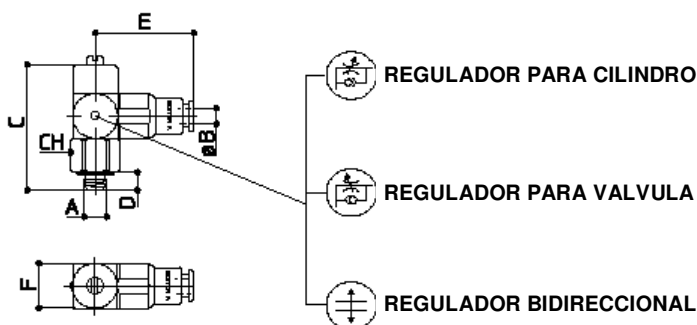

CODIGO	A	B	C	D	E	F	CH	Ø	Q⇒R	R⇒Q	Gr
SR64M5M5/C	M5	M5	29	4	13	10	10	1,2	0-70 NI/min	140 NI/min	19
SR64M5M5/V	M5	M5	29	4	13	10	10	1,2	0-70 NI/min	140 NI/min	19
SR64M5M5/B	M5	M5	29	4	13	10	10	1,2	0-70 NI/min	140 NI/min	19

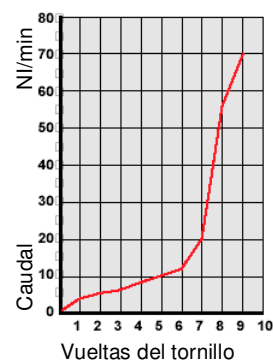

## SR65/C – SR65/V – SR65/B SR65 MINI REGULADOR CONICO MACHO

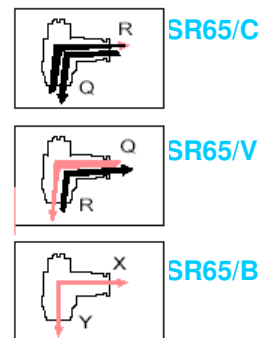
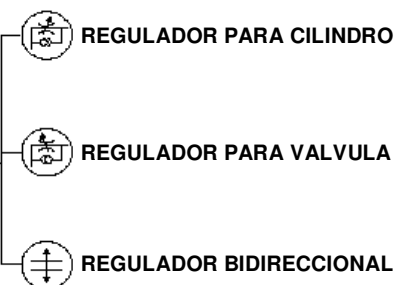
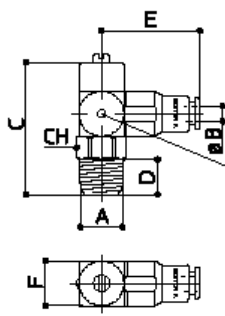

CODIGO	A	B	C	D	E	F	CH	Ø	Q⇒R	R⇒Q	Gr
SR650418/C	1/8	4	29,5	8	22,5	10	10	1,2	0-70 NI/min	140 NI/min	21
SR650518/C	1/8	5	29,5	8	22,5	10	10	1,2	0-70 NI/min	140 NI/min	21
SR650618/C	1/8	6	29,5	8	24	12	10	1,2	0-70 NI/min	140 NI/min	30
SR650418/V	1/8	4	29,5	8	22,5	10	10	1,2	0-70 NI/min	140 NI/min	21
SR650518/V	1/8	5	29,5	8	22,5	10	10	1,2	0-70 NI/min	140 NI/min	21
SR650618/V	1/8	6	29,5	8	24	12	10	1,2	0-70 NI/min	140 NI/min	30
SR650418/B	1/8	4	29,5	8	22,5	10	10	1,2	0-70 NI/min	140 NI/min	21
SR650518/B	1/8	5	29,5	8	22,5	10	10	1,2	0-70 NI/min	140 NI/min	21
SR650618/B	1/8	6	29,5	8	24	12	10	1,2	0-70 NI/min	140 NI/min	30

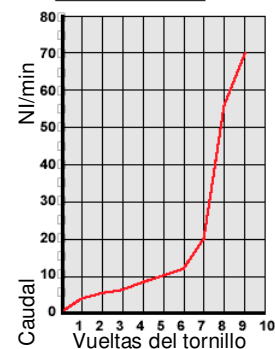

## SR66/C – SR66/V – SR66/B SR66 REGULADOR CONICO MACHO

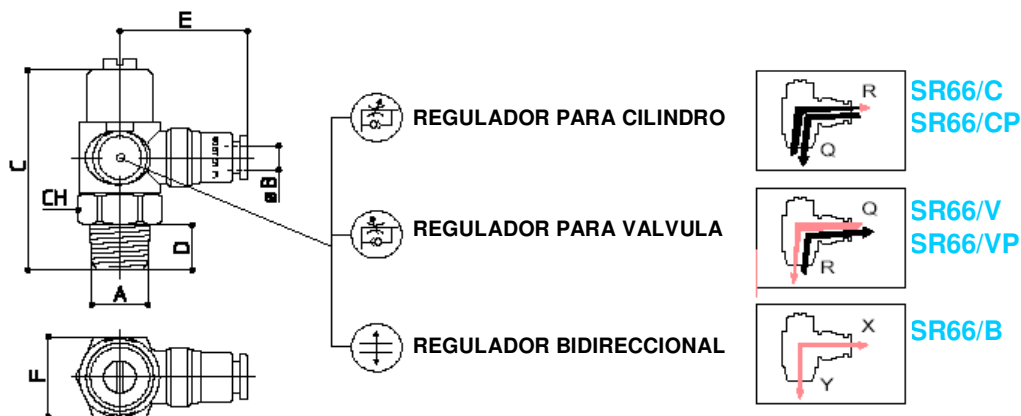

CODIGO	A	B	C	D	E	F	CH	Ø	Q⇒R	R⇒Q	Gr
SR660418/C	1/8	4	38	8	24	15,5	14	2	0-200 NI/min	200 NI/min	38
SR660518/C	1/8	5	38	8	24	15,5	14	3	0-400 NI/min	360 NI/min	40
SR660618/C	1/8	6	38	8	27	15,5	14	3,5	0-600 NI/min	480 NI/min	42
SR660614/C	1/4	6	44,5	10	28,5	17,8	16	4	0-600 NI/min	500 NI/min	63
SR660818/C	1/8	8	38	8	29	15,5	14	3,5	0-680 NI/min	500 NI/min	44
SR660814/C	1/4	8	44,5	10	30	17,8	16	4,5	0-850 NI/min	650 NI/min	65
SR661014/C	1/4	10	44,5	10	3	178	16	4,5	0-900 NI/min	700 NI/min	68
SR660418/CP	1/8	4	38	8	24	15,5	14	2	0-200 NI/min	200 NI/min	38
SR660518/CP	1/8	5	38	8	24	15,5	14	3	0-400 NI/min	360 NI/min	40
SR660618/CP	1/8	6	38	8	27	15,5	14	3,5	0-600 NI/min	480 NI/min	42
SR660614/CP	1/4	6	44,5	10	28,5	17,8	16	4	0-600 NI/min	500 NI/min	63
SR660818/CP	1/8	8	38	8	29	15,5	14	3,5	0-680 NI/min	500 NI/min	44
SR660814/CP	1/4	8	44,5	10	30	17,8	16	4,5	0-850 NI/min	650 NI/min	65
SR661014/CP	1/4	10	44,5	10	3	178	16	4,5	0-900 NI/min	700 NI/min	68
SR660418/V	1/8	4	38	8	24	15,5	14	2	0-200 NI/min	200 NI/min	38
SR660518/V	1/8	5	38	8	24	15,5	14	3	0-400 NI/min	360 NI/min	40
SR660618/V	1/8	6	38	8	27	15,5	14	3,5	0-600 NI/min	480 NI/min	42
SR660614/V	1/4	6	44,5	10	28,5	17,8	16	4	0-600 NI/min	500 NI/min	63
SR660818/V	1/8	8	38	8	29	15,5	14	3,5	0-680 NI/min	500 NI/min	44
SR660814/V	1/4	8	44,5	10	30	17,8	16	4,5	0-850 NI/min	650 NI/min	65
SR661014/V	1/4	10	44,5	10	3	178	16	4,5	0-900 NI/min	700 NI/min	68
SR660418/VP	1/8	4	38	8	24	15,5	14	2	0-200 NI/min	200 NI/min	38
SR660518/VP	1/8	5	38	8	24	15,5	14	3	0-400 NI/min	360 NI/min	40
SR660618/VP	1/8	6	38	8	27	15,5	14	3,5	0-600 NI/min	480 NI/min	42
SR660614/VP	1/4	6	44,5	10	28,5	17,8	16	4	0-600 NI/min	500 NI/min	63
SR660818/VP	1/8	8	38	8	29	15,5	14	3,5	0-680 NI/min	500 NI/min	44
SR660814/VP	1/4	8	44,5	10	30	17,8	16	4,5	0-850 NI/min	650 NI/min	65
SR661014/VP	1/4	10	44,5	10	3	178	16	4,5	0-900 NI/min	700 NI/min	68
SR660418/B	1/8	4	38	8	24	15,5	14	2	0-200 NI/min	200 NI/min	38
SR660518/B	1/8	5	38	8	24	15,5	14	3	0-400 NI/min	360 NI/min	40
SR660618/B	1/8	6	38	8	27	15,5	14	3,5	0-600 NI/min	480 NI/min	42
SR660614/B	1/4	6	44,5	10	28,5	17,8	16	4	0-600 NI/min	500 NI/min	63
SR660818/B	1/8	8	38	8	29	15,5	14	3,5	0-680 NI/min	500 NI/min	44
SR660814/B	1/4	8	44,5	10	30	17,8	16	4,5	0-850 NI/min	650 NI/min	65
SR661014/B	1/4	10	44,5	10	3	178	16	4,5	0-900 NI/min	700 NI/min	68

## SR67/C – SR67/V – SR67/B SR67 MAXI REGULADOR CONICO MACHO

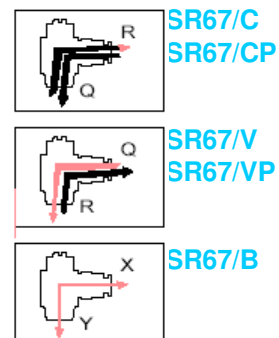
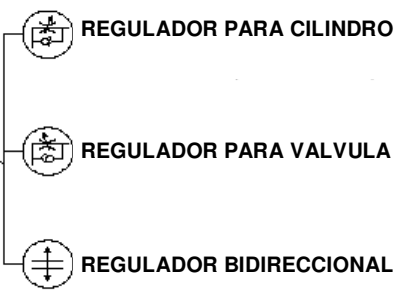
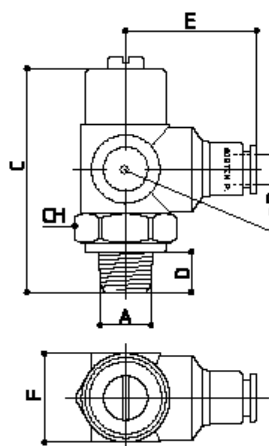

CODIGO	A	B	C	D	E	F	CH	Ø	Q→R	R→Q	Gr
SR670814/C	1/4	8	56	10	32,5	23	22	6	0-1300 NI/min	1000 NI/min	127
SR670838/C	3/8	8	57	11	32,5	23	22	6	0-1450 NI/min	1000 NI/min	131
SR671014/C	1/4	10	56	10	33,5	23	22	7	0-1700 NI/min	1100 NI/min	131
SR671038/C	3/8	10	57	11	33,5	23	22	7	0-1700 NI/min	1250 NI/min	134
SR671238/C	3/8	12	57	11	37	23	22	7	0-1750 NI/min	1300 NI/min	137
SR671212/C	1/2	12	60	14	37	23	22	7	0-1800 NI/min	1300 NI/min	154
SR670814/CP	1/4	8	56	10	32,5	23	22	6	0-1300 NI/min	1000 NI/min	127
SR670838/CP	3/8	8	57	11	32,5	23	22	6	0-1450 NI/min	1000 NI/min	131
SR671014/CP	1/4	10	56	10	33,5	23	22	7	0-1700 NI/min	1100 NI/min	131
SR671038/CP	3/8	10	57	11	33,5	23	22	7	0-1700 NI/min	1250 NI/min	134
SR671238/CP	3/8	12	57	11	37	23	22	7	0-1750 NI/min	1300 NI/min	137
SR671212/CP	1/2	12	60	14	37	23	22	7	0-1800 NI/min	1300 NI/min	154
SR670814/V	1/4	8	56	10	32,5	23	22	6	0-1300 NI/min	1000 NI/min	127
SR670838/V	3/8	8	57	11	32,5	23	22	6	0-1450 NI/min	1000 NI/min	131
SR671014/V	1/4	10	56	10	33,5	23	22	7	0-1700 NI/min	1100 NI/min	131
SR671038/V	3/8	10	57	11	33,5	23	22	7	0-1700 NI/min	1250 NI/min	134
SR671238/V	3/8	12	57	11	37	23	22	7	0-1750 NI/min	1300 NI/min	137
SR671212/V	1/2	12	60	14	37	23	22	7	0-1800 NI/min	1300 NI/min	154
SR670814/VP	1/4	8	56	10	32,5	23	22	6	0-1300 NI/min	1000 NI/min	127
SR670838/VP	3/8	8	57	11	32,5	23	22	6	0-1450 NI/min	1000 NI/min	131
SR671014/VP	1/4	10	56	10	33,5	23	22	7	0-1700 NI/min	1100 NI/min	131
SR671038/VP	3/8	10	57	11	33,5	23	22	7	0-1700 NI/min	1250 NI/min	134
SR671238/VP	3/8	12	57	11	37	23	22	7	0-1750 NI/min	1300 NI/min	137
SR671212/VP	1/2	12	60	14	37	23	22	7	0-1800 NI/min	1300 NI/min	154
SR670814/B	1/4	8	56	10	32,5	23	22	6	0-1300 NI/min	1000 NI/min	127
SR670838/B	3/8	8	57	11	32,5	23	22	6	0-1450 NI/min	1000 NI/min	131
SR671014/B	1/4	10	56	10	33,5	23	22	7	0-1700 NI/min	1100 NI/min	131
SR671038/B	3/8	10	57	11	33,5	23	22	7	0-1700 NI/min	1250 NI/min	134
SR671238/B	3/8	12	57	11	37	23	22	7	0-1750 NI/min	1300 NI/min	137
SR671212/B	1/2	12	60	14	37	23	22	7	0-1800 NI/min	1300 NI/min	154

## SR68/C – SR68/V – SR68/B

SR68 REGULADOR CONICO MACHO CILINDRICO HEMBRA

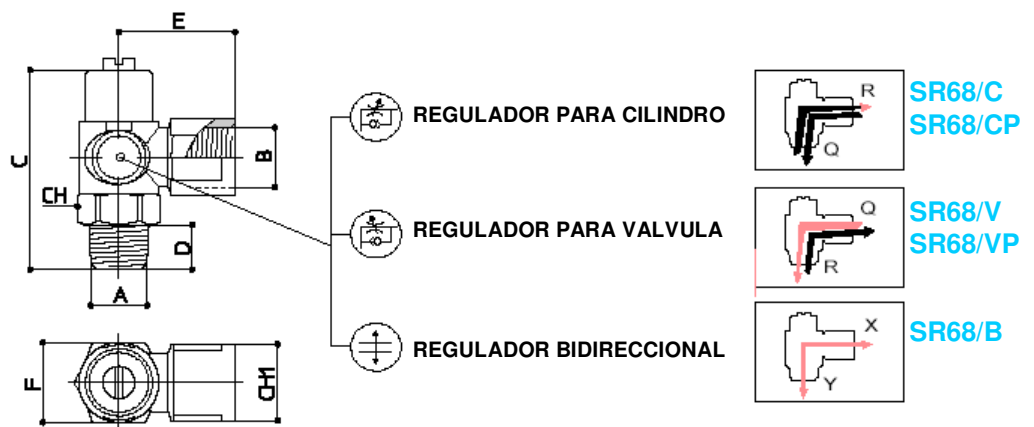

CODIGO	A	B	C	D	E	F	CH	CH1	Ø	Q⇒R	R⇒Q	Gr
SR68M518/C	1/8	M5	29,5	8	13	10	10	-	1,2	0-70 NI/min	140 NI/min	21
SR681818/C	1/8	1/8	38	8	21,5	15,5	14	13	3,5	0-600 NI/min	480 NI/min	43
SR681414/C	1/4	1/4	44,5	10	26	17,8	16	17	4,5	0-850 NI/min	650 NI/min	62
SR683838/C	3/8	3/8	57	11	26,5	23	22	21	7	0-1700 NI/min	1250 NI/min	129
SR681212/C	1/2	1/2	60	14	33,5	23	22	26	7	0-1800 NI/min	1300 NI/min	163
SR68M518/CP	1/8	M5	29,5	8	13	10	10	-	1,2	0-70 NI/min	140 NI/min	21
SR681818/CP	1/8	1/8	38	8	21,5	15,5	14	13	3,5	0-600 NI/min	480 NI/min	43
SR681414/CP	1/4	1/4	44,5	10	26	17,8	16	17	4,5	0-850 NI/min	650 NI/min	62
SR683838/CP	3/8	3/8	57	11	26,5	23	22	21	7	0-1700 NI/min	1250 NI/min	129
SR681212/CP	1/2	1/2	60	14	33,5	23	22	26	7	0-1800 NI/min	1300 NI/min	163
SR68M518/V	1/8	M5	29,5	8	13	10	10	-	1,2	0-70 NI/min	140 NI/min	21
SR681818/V	1/8	1/8	38	8	21,5	15,5	14	13	3,5	0-600 NI/min	480 NI/min	43
SR681414/V	1/4	1/4	44,5	10	26	17,8	16	17	4,5	0-850 NI/min	650 NI/min	62
SR683838/V	3/8	3/8	57	11	26,5	23	22	21	7	0-1700 NI/min	1250 NI/min	129
SR681212/V	1/2	1/2	60	14	33,5	23	22	26	7	0-1800 NI/min	1300 NI/min	163
SR68M518/VP	1/8	M5	29,5	8	13	10	10	-	1,2	0-70 NI/min	140 NI/min	21
SR681818/VP	1/8	1/8	38	8	21,5	15,5	14	13	3,5	0-600 NI/min	480 NI/min	43
SR681414/VP	1/4	1/4	44,5	10	26	17,8	16	17	4,5	0-850 NI/min	650 NI/min	62
SR683838/VP	3/8	3/8	57	11	26,5	23	22	21	7	0-1700 NI/min	1250 NI/min	129
SR681212/VP	1/2	1/2	60	14	33,5	23	22	26	7	0-1800 NI/min	1300 NI/min	163
SR68M518/B	1/8	M5	29,5	8	13	10	10	-	1,2	0-70 NI/min	140 NI/min	21
SR681818/B	1/8	1/8	38	8	21,5	15,5	14	13	3,5	0-600 NI/min	480 NI/min	43
SR681414/B	1/4	1/4	44,5	10	26	17,8	16	17	4,5	0-850 NI/min	650 NI/min	62
SR683838/B	3/8	3/8	57	11	26,5	23	22	21	7	0-1700 NI/min	1250 NI/min	129
SR681212/B	1/2	1/2	60	14	33,5	23	22	26	7	0-1800 NI/min	1300 NI/min	163

**SR69/C – SR69/V – SR69/B**  
SR69 REGULADOR CILINDRICO MACHO

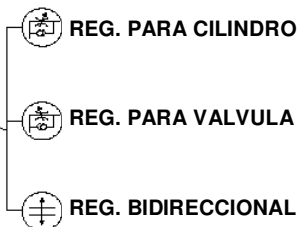
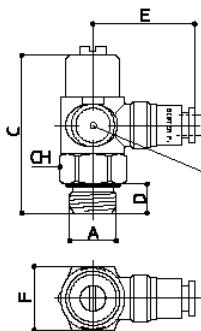

SR69/C  
SR69/CP



SR69/V  
SR69/VP



SR69/B

CODIGO	A	B	C	D	E	F	CH	Ø	Q→R	R→Q	Gr
SR6904M5/C	M5	4	37,5	4	24	15,5	14	2	0-170 NI/min	180 NI/min	40
SR690418/C	1/8	4	38	6	24	15,5	14	2	0-200 NI/min	200 NI/min	41
SR6905M5/C	M5	5	37,5	4	24	15,5	14	2,5	0-330 NI/min	220 NI/min	41
SR690518/C	1/8	5	38	6	24	15,5	14	3	0-400 NI/min	360 NI/min	43
SR6906M5/C	M5	6	37,5	4	27	15,5	14	2,5	0-360 NI/min	260 NI/min	43
SR690618/C	1/8	6	38	6	27	15,5	14	3,5	0-600 NI/min	480 NI/min	44
SR690614/C	1/4	6	44	8	28,5	17,8	16	4	0-600 NI/min	500 NI/min	67
SR690818/C	1/8	8	38	6	29	15,5	14	3,5	0-680 NI/min	500 NI/min	43
SR690814/C	1/4	8	44	8	30	17,8	16	4,5	0-850 NI/min	650 NI/min	68
SR691014/C	1/4	10	44	8	31	17,8	16	4,5	0-900 NI/min	700 NI/min	68
SR6904M5/CP	M5	4	37,5	4	24	15,5	14	2	0-170 NI/min	180 NI/min	40
SR690418/CP	1/8	4	38	6	24	15,5	14	2	0-200 NI/min	200 NI/min	41
SR6905M5/CP	M5	5	37,5	4	24	15,5	14	2,5	0-330 NI/min	220 NI/min	41
SR690518/CP	1/8	5	38	6	24	15,5	14	3	0-400 NI/min	360 NI/min	43
SR6906M5/CP	M5	6	37,5	4	27	15,5	14	2,5	0-360 NI/min	260 NI/min	43
SR690618/CP	1/8	6	38	6	27	15,5	14	3,5	0-600 NI/min	480 NI/min	44
SR690614/CP	1/4	6	44	8	28,5	17,8	16	4	0-600 NI/min	500 NI/min	67
SR690818/CP	1/8	8	38	6	29	15,5	14	3,5	0-680 NI/min	500 NI/min	43
SR690814/CP	1/4	8	44	8	30	17,8	16	4,5	0-850 NI/min	650 NI/min	68
SR691014/CP	1/4	10	44	8	31	17,8	16	4,5	0-900 NI/min	700 NI/min	68
SR6904M5/V	M5	4	37,5	4	24	15,5	14	2	0-170 NI/min	180 NI/min	40
SR690418/V	1/8	4	38	6	24	15,5	14	2	0-200 NI/min	200 NI/min	41
SR6905M5/V	M5	5	37,5	4	24	15,5	14	2,5	0-330 NI/min	220 NI/min	41
SR690518/V	1/8	5	38	6	24	15,5	14	3	0-400 NI/min	360 NI/min	43
SR6906M5/V	M5	6	37,5	4	27	15,5	14	2,5	0-360 NI/min	260 NI/min	43
SR690618/V	1/8	6	38	6	27	15,5	14	3,5	0-600 NI/min	480 NI/min	44
SR690614/V	1/4	6	44	8	28,5	17,8	16	4	0-600 NI/min	500 NI/min	67
SR690818/V	1/8	8	38	6	29	15,5	14	3,5	0-680 NI/min	500 NI/min	43
SR690814/V	1/4	8	44	8	30	17,8	16	4,5	0-850 NI/min	650 NI/min	68
SR691014/V	1/4	10	44	8	31	17,8	16	4,5	0-900 NI/min	700 NI/min	68
SR6904M5/VP	M5	4	37,5	4	24	15,5	14	2	0-170 NI/min	180 NI/min	40
SR690418/VP	1/8	4	38	6	24	15,5	14	2	0-200 NI/min	200 NI/min	41
SR6905M5/VP	M5	5	37,5	4	24	15,5	14	2,5	0-330 NI/min	220 NI/min	41
SR690518/VP	1/8	5	38	6	24	15,5	14	3	0-400 NI/min	360 NI/min	43
SR6906M5/VP	M5	6	37,5	4	27	15,5	14	2,5	0-360 NI/min	260 NI/min	43
SR690618/VP	1/8	6	38	6	27	15,5	14	3,5	0-600 NI/min	480 NI/min	44
SR690614/VP	1/4	6	44	8	28,5	17,8	16	4	0-600 NI/min	500 NI/min	67
SR690818/VP	1/8	8	38	6	29	15,5	14	3,5	0-680 NI/min	500 NI/min	43
SR690814/VP	1/4	8	44	8	30	17,8	16	4,5	0-850 NI/min	650 NI/min	68
SR691014/VP	1/4	10	44	8	31	17,8	16	4,5	0-900 NI/min	700 NI/min	68
SR6904M5/B	M5	4	37,5	4	24	15,5	14	2	0-170 NI/min	180 NI/min	40
SR690418/B	1/8	4	38	6	24	15,5	14	2	0-200 NI/min	200 NI/min	41
SR6905M5/B	M5	5	37,5	4	24	15,5	14	2,5	0-330 NI/min	220 NI/min	41
SR690518/B	1/8	5	38	6	24	15,5	14	3	0-400 NI/min	360 NI/min	43
SR6906M5/B	M5	6	37,5	4	27	15,5	14	2,5	0-360 NI/min	260 NI/min	43
SR690618/B	1/8	6	38	6	27	15,5	14	3,5	0-600 NI/min	480 NI/min	44
SR690614/B	1/4	6	44	8	28,5	17,8	16	4	0-600 NI/min	500 NI/min	67
SR690818/B	1/8	8	38	6	29	15,5	14	3,5	0-680 NI/min	500 NI/min	43
SR690814/B	1/4	8	44	8	30	17,8	16	4,5	0-850 NI/min	650 NI/min	68
SR691014/B	1/4	10	44	8	31	17,8	16	4,5	0-900 NI/min	700 NI/min	68

## SR70/C – SR70/V – SR70/B SR70 MAXI REGULADOR CILINDRICO MACHO

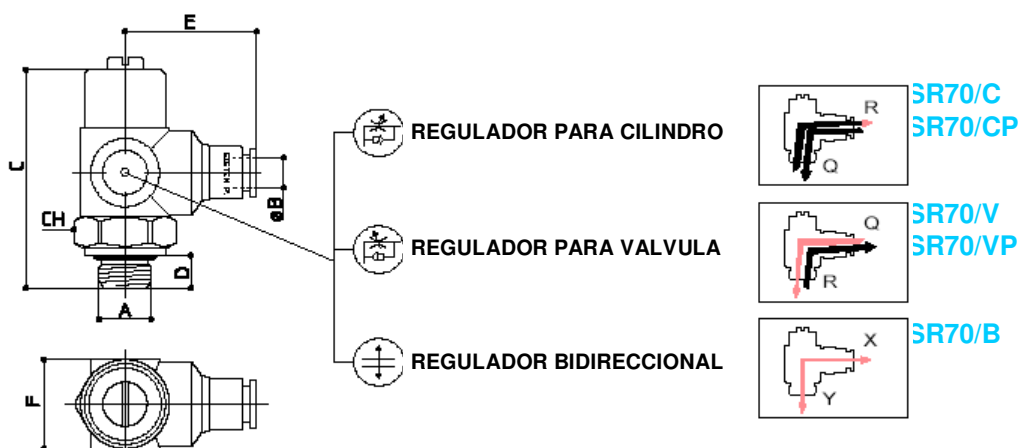

CODIGO	A	B	C	D	E	F	CH	Ø	Q⇒R	R⇒Q	Gr
SR700814/C	1/4	8	54	8	32,5	23	22	6	0-1300 NI/min	1000 NI/min	124
SR700838/C	3/8	8	57	10	32,5	23	22	6	0-1450 NI/min	1000 NI/min	131
SR701014/C	1/4	10	54	8	33,5	23	22	7	0-1700 NI/min	1100 NI/min	126
SR701038/C	3/8	10	57	10	33,5	23	22	7	0-1700 NI/min	1250 NI/min	134
SR701238/C	3/8	12	57	10	37	23	22	7	0-1750 NI/min	1300 NI/min	142
SR701212/C	1/2	12	59	12	37	23	24	7	0-1800 NI/min	1300 NI/min	155
SR700814/CP	1/4	8	54	8	32,5	23	22	6	0-1300 NI/min	1000 NI/min	124
SR700838/CP	3/8	8	57	10	32,5	23	22	6	0-1450 NI/min	1000 NI/min	131
SR701014/CP	1/4	10	54	8	33,5	23	22	7	0-1700 NI/min	1100 NI/min	126
SR701038/CP	3/8	10	57	10	33,5	23	22	7	0-1700 NI/min	1250 NI/min	134
SR701238/CP	3/8	12	57	10	37	23	22	7	0-1750 NI/min	1300 NI/min	142
SR701212/CP	1/2	12	59	12	37	23	24	7	0-1800 NI/min	1300 NI/min	155
SR700814/V	1/4	8	54	8	32,5	23	22	6	0-1300 NI/min	1000 NI/min	124
SR700838/V	3/8	8	57	10	32,5	23	22	6	0-1450 NI/min	1000 NI/min	131
SR701014/V	1/4	10	54	8	33,5	23	22	7	0-1700 NI/min	1100 NI/min	126
SR701038/V	3/8	10	57	10	33,5	23	22	7	0-1700 NI/min	1250 NI/min	134
SR701238/V	3/8	12	57	10	37	23	22	7	0-1750 NI/min	1300 NI/min	142
SR701212/V	1/2	12	59	12	37	23	24	7	0-1800 NI/min	1300 NI/min	155
SR700814/VP	1/4	8	54	8	32,5	23	22	6	0-1300 NI/min	1000 NI/min	124
SR700838/VP	3/8	8	57	10	32,5	23	22	6	0-1450 NI/min	1000 NI/min	131
SR701014/VP	1/4	10	54	8	33,5	23	22	7	0-1700 NI/min	1100 NI/min	126
SR701038/VP	3/8	10	57	10	33,5	23	22	7	0-1700 NI/min	1250 NI/min	134
SR701238/VP	3/8	12	57	10	37	23	22	7	0-1750 NI/min	1300 NI/min	142
SR701212/VP	1/2	12	59	12	37	23	24	7	0-1800 NI/min	1300 NI/min	155
SR700814/B	1/4	8	54	8	32,5	23	22	6	0-1300 NI/min	1000 NI/min	124
SR700838/B	3/8	8	57	10	32,5	23	22	6	0-1450 NI/min	1000 NI/min	131
SR701014/B	1/4	10	54	8	33,5	23	22	7	0-1700 NI/min	1100 NI/min	126
SR701038/B	3/8	10	57	10	33,5	23	22	7	0-1700 NI/min	1250 NI/min	134
SR701238/B	3/8	12	57	10	37	23	22	7	0-1750 NI/min	1300 NI/min	142
SR701212/B	1/2	12	59	12	37	23	24	7	0-1800 NI/min	1300 NI/min	155



**SR71/C – SR71/V – SR71/B**  
SR71 REGULADOR CILINDRICO MACHO/HEMBRA

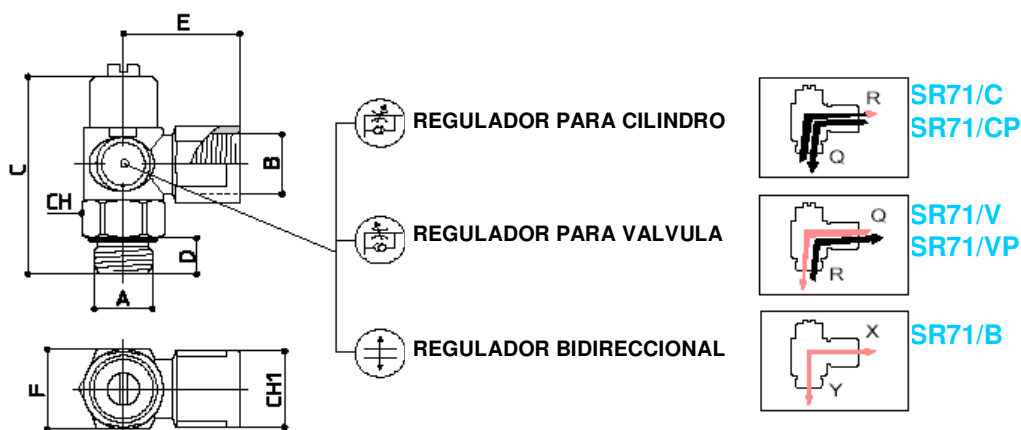

CODIGO	A	B	C	D	E	F	CH	CH1	Ø	Q→R	R→Q	Gr
SR711818/C	1/8	1/8	38	6	21,5	15,5	14	13	3,5	0-600 NI/min	480 NI/min	43
SR711414/C	1/4	1/4	44	8	26	17,8	16	17	4,5	0-850 NI/min	650 NI/min	62
SR713838/C	3/8	3/8	57	10	26,5	23	22	21	7	0-1700 NI/min	1250 NI/min	129
SR711212/C	1/2	1/2	59	12	33,5	23	24	26	7	0-1800 NI/min	1300 NI/min	163
SR711818/CP	1/8	1/8	38	6	21,5	15,5	14	13	3,5	0-600 NI/min	480 NI/min	43
SR711414/CP	1/4	1/4	44	8	26	17,8	16	17	4,5	0-850 NI/min	650 NI/min	62
SR713838/CP	3/8	3/8	57	10	26,5	23	22	21	7	0-1700 NI/min	1250 NI/min	129
SR711212/CP	1/2	1/2	59	12	33,5	23	24	26	7	0-1800 NI/min	1300 NI/min	163
SR711818/V	1/8	1/8	38	6	21,5	15,5	14	13	3,5	0-600 NI/min	480 NI/min	43
SR711414/V	1/4	1/4	44	8	26	17,8	16	17	4,5	0-850 NI/min	650 NI/min	62
SR713838/V	3/8	3/8	57	10	26,5	23	22	21	7	0-1700 NI/min	1250 NI/min	129
SR711212/V	1/2	1/2	59	12	33,5	23	24	26	7	0-1800 NI/min	1300 NI/min	163
SR711818/VP	1/8	1/8	38	6	21,5	15,5	14	13	3,5	0-600 NI/min	480 NI/min	43
SR711414/VP	1/4	1/4	44	8	26	17,8	16	17	4,5	0-850 NI/min	650 NI/min	62
SR713838/VP	3/8	3/8	57	10	26,5	23	22	21	7	0-1700 NI/min	1250 NI/min	129
SR711212/VP	1/2	1/2	59	12	33,5	23	24	26	7	0-1800 NI/min	1300 NI/min	163
SR711818/B	1/8	1/8	38	6	21,5	15,5	14	13	3,5	0-600 NI/min	480 NI/min	43
SR711414/B	1/4	1/4	44	8	26	17,8	16	17	4,5	0-850 NI/min	650 NI/min	62
SR713838/B	3/8	3/8	57	10	26,5	23	22	21	7	0-1700 NI/min	1250 NI/min	129
SR711212/B	1/2	1/2	59	12	33,5	23	24	26	7	0-1800 NI/min	1300 NI/min	163

**SR72/C – SR72/V – SR72/B**  
SR72 REGULADOR CILINDRICO HEMBRA/HEMBRA

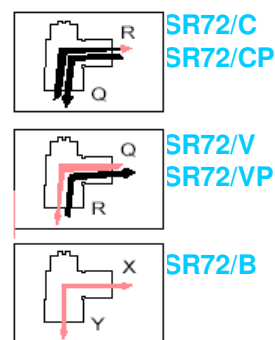
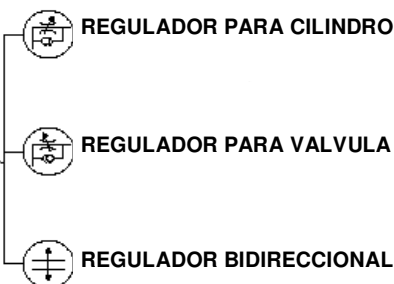
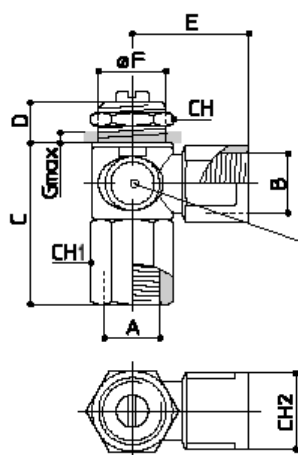

CODIGO	A	B	C	D	E	F	G	CH	CH1	CH2	Ø	Q→R	R→Q	Gr
SR721818/C	1/8	1/8	33	9	21,5	M12x100	6	14	14	13	3,5	0-600 NI/min	480 NI/min	51
SR721414/C	1/4	1/4	36	9	26	M15x100	6	18	16	17	4,5	0-850 NI/min	650 NI/min	68
SR723838/C	3/8	3/8	44	12	26,5	M17x100	9	20	21	21	7	0-1700 NI/min	1250 NI/min	145
SR721818/CP	1/8	1/8	33	9	21,5	M12x100	6	14	14	13	3,5	0-600 NI/min	480 NI/min	51
SR721414/CP	1/4	1/4	36	9	26	M15x100	6	18	16	17	4,5	0-850 NI/min	650 NI/min	68
SR723838/CP	3/8	3/8	44	12	26,5	M17x100	9	20	21	21	7	0-1700 NI/min	1250 NI/min	145
SR721818/V	1/8	1/8	33	9	21,5	M12x100	6	14	14	13	3,5	0-600 NI/min	480 NI/min	51
SR721414/V	1/4	1/4	36	9	26	M15x100	6	18	16	17	4,5	0-850 NI/min	650 NI/min	68
SR723838/V	3/8	3/8	44	12	26,5	M17x100	9	20	21	21	7	0-1700 NI/min	1250 NI/min	145
SR721818/VP	1/8	1/8	33	9	21,5	M12x100	6	14	14	13	3,5	0-600 NI/min	480 NI/min	51
SR721414/VP	1/4	1/4	36	9	26	M15x100	6	18	16	17	4,5	0-850 NI/min	650 NI/min	68
SR723838/VP	3/8	3/8	44	12	26,5	M17x100	9	20	21	21	7	0-1700 NI/min	1250 NI/min	145
SR721818/B	1/8	1/8	33	9	21,5	M12x100	6	14	14	13	3,5	0-600 NI/min	480 NI/min	51
SR721414/B	1/4	1/4	36	9	26	M15x100	6	18	16	17	4,5	0-850 NI/min	650 NI/min	68
SR723838/B	3/8	3/8	44	12	26,5	M17x100	9	20	21	21	7	0-1700 NI/min	1250 NI/min	145

**SR73/C – SR73/V – SR73/B**  
SR73 REGULADOR TUBO/TUBO

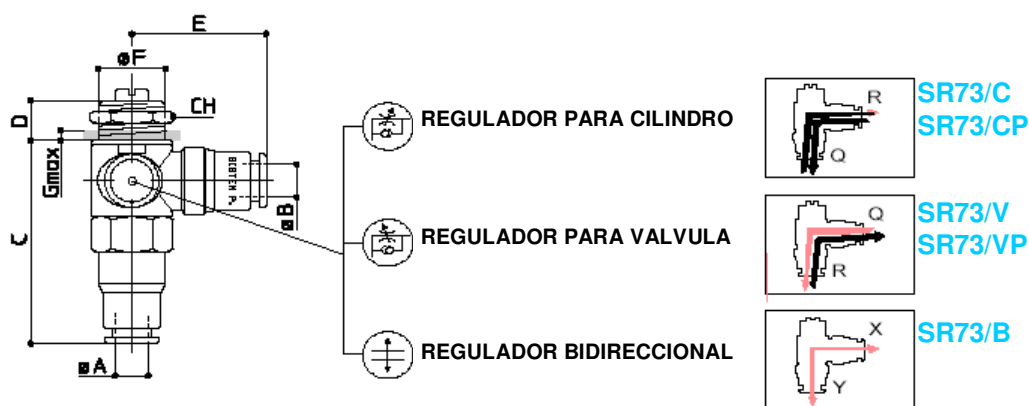

CODIGO	A	B	C	D	E	F	G	CH	Ø	Q⇒R	R⇒Q	Gr
SR730606/C	6	6	42	9	27	M12x100	6	18	3,5	0-600 NI/min	480 NI/min	52
SR730808/C	8	8	45,5	9	30	M15x100	6	18	4,5	0-850 NI/min	650 NI/min	78
SR731010/C	10	10	57	12	33,5	M17x100	9	20	7	0-1700 NI/min	1250 NI/min	145
SR731212/C	12	12	57,5	12	37	M17x100	9	20	7	0-1800 NI/min	1300 NI/min	149
SR730606/CP	6	6	42	9	27	M12x100	6	18	3,5	0-600 NI/min	480 NI/min	52
SR730808/CP	8	8	45,5	9	30	M15x100	6	18	4,5	0-850 NI/min	650 NI/min	78
SR731010/CP	10	10	57	12	33,5	M17x100	9	20	7	0-1700 NI/min	1250 NI/min	145
SR731212/CP	12	12	57,5	12	37	M17x100	9	20	7	0-1800 NI/min	1300 NI/min	149
SR730606/V	6	6	42	9	27	M12x100	6	18	3,5	0-600 NI/min	480 NI/min	52
SR730808/V	8	8	45,5	9	30	M15x100	6	18	4,5	0-850 NI/min	650 NI/min	78
SR731010/V	10	10	57	12	33,5	M17x100	9	20	7	0-1700 NI/min	1250 NI/min	145
SR731212/V	12	12	57,5	12	37	M17x100	9	20	7	0-1800 NI/min	1300 NI/min	149
SR730606/VP	6	6	42	9	27	M12x100	6	18	3,5	0-600 NI/min	480 NI/min	52
SR730808/VP	8	8	45,5	9	30	M15x100	6	18	4,5	0-850 NI/min	650 NI/min	78
SR731010/VP	10	10	57	12	33,5	M17x100	9	20	7	0-1700 NI/min	1250 NI/min	145
SR731212/VP	12	12	57,5	12	37	M17x100	9	20	7	0-1800 NI/min	1300 NI/min	149
SR730606/B	6	6	42	9	27	M12x100	6	18	3,5	0-600 NI/min	480 NI/min	52
SR730808/B	8	8	45,5	9	30	M15x100	6	18	4,5	0-850 NI/min	650 NI/min	78
SR731010/B	10	10	57	12	33,5	M17x100	9	20	7	0-1700 NI/min	1250 NI/min	145
SR731212/B	12	12	57,5	12	37	M17x100	9	20	7	0-1800 NI/min	1300 NI/min	149