

SO11 RECTO CONICO MACHO

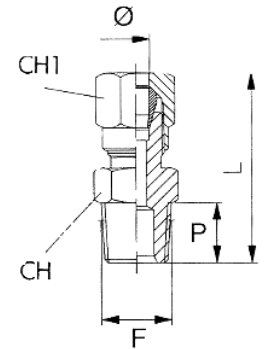

CODIGO	Ø	F	P	L	E	F	G	CH	CH1	Gr
SO110418	4	1/8	8	27,5				11	10	
SO110414	4	1/4	11	30,5				14	10	
SO110618	6	1/8	8	27,5				11	12	
SO110614	6	1/4	11	31,5				14	12	
SO110638	6	3/8	11	31,5				17	12	
SO110612	6	1/2	14	34				22	12	
SO110718	7	1/8								
SO110818	8	1/8	8	31				12	14	
SO110814	8	1/4	11	33				14	14	
SO110838	8	3/8	11,5	33				17	14	
SO111014	10	1/4	11	33				14	17	
SO111038	10	3/8	11,5	38				17	19	
SO111012	10	1/2	14	40,5				22	19	
SO111214	12	1/4	11	33				17	19	
SO111238	12	3/8	11	33,5				17	19	
SO111212	12	1/2	14	41				22	22	
SO111412	14	1/2	14	40				22	22	
SO111512	15	1/2	14	40				22	22	
SO111612	16	1/2	14	45				24	30	
SO111812	18	1/2	14	45				26	32	



SO12 RECTO CILINDRICO MACHO



CODIGO	Ø	F	P	L	E	F	G	CH	CH1	Gr
SO120418	4	1/8	6	25				14	10	
SO120618	6	1/8	6	25,5				14	12	
SO120614	6	1/4	8	28,5				17	12	
SO120818	8	1/8	6	27,5				14	14	
SO120814	8	1/4	8	30				17	14	
SO120838	8	3/8	9	30,5				19	14	
SO121014	10	1/4	8	30				17	17	
SO121038	10	3/8	9	36				19	19	

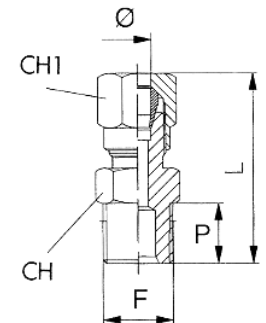

SO13 RECTO HEMBRA



CODIGO	Ø	F	P	L	E	F	G	CH	CH1	Gr
SO130418	4	1/8	8	27				14	10	
SO130618	6	1/8	8	28				14	12	
SO130614	6	1/4	10	31				16	12	
SO130818	8	1/8	8	29,5				14	14	
SO130814	8	1/4	10	32,5				16	14	
SO130838	8	3/8	11,5	31				20	14	
SO131014	10	1/4	10	32				17	17	
SO131038	10	3/8	11	34				19	17	
SO131012	10	1/2	14	35				24	17	
SO131238	12	3/8								
SO131212	12	1/2								
SO131412	14	1/2								
SO131512	15	1/2								
SO131612	16	1/2								
SO131812	18	1/2								

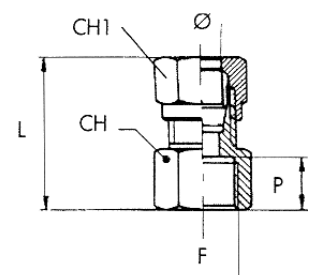

SO14 PROLONGADOR



CODIGO	Ø	Ø1	L	D	E	F	CH	CH1	CH2	Gr
SO140400	4	4	35				10	10	10	
SO140600	6	6	37				12	12	12	
SO140806	8	6	38,5				14	12	14	
SO140800	8	8	40				14	14	14	
SO141000	10	10	42				17	17	17	
SO141200	12	12	42				19	19	19	
SO141400	14	14	47				22	22	22	
SO141500	15	15	49				24	24	24	
SO141600	16	16								
SO141800	18	18								

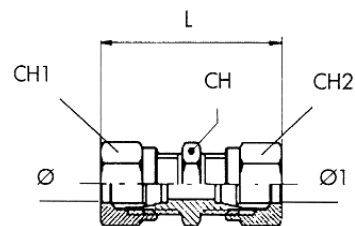

SO15 PROLONGADOR PASATABIQUES



CODIGO	Ø	L	C	D	E	F	G	CH	CH1	Gr
SO150600	6	51,5						14	12	
SO150800	8	55,5						16	14	
SO151000	10	58						17	17	
SO151200	12	66						19	19	
SO151400	14	69,5						25	27	
SO151500	15	69,5						25	27	

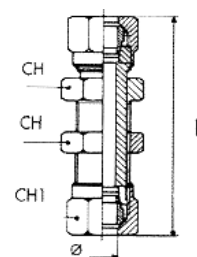

SO16 CODO CONICO MACHO



CODIGO	Ø	F	P	L	L1	F	G	CH	CH1	Gr
SO160418	4	1/8	8	18	24			9	10	
SO160618	6	1/8	8	16	23			9	12	
SO160614	6	1/4	11	20	24,5			11	12	
SO160818	8	1/8	8	17	24			11	14	
SO160814	8	1/4	11	20	24			11	14	
SO160838	8	3/8	11,5	24	27			13	14	
SO160812	8	1/2	-	-	-			-	-	
SO161018	10	1/8	8	21,5	25			13	17	
SO161014	10	1/4	11	23,5	32			13	19	
SO161038	10	3/8	11,5	24	32			13	19	
SO161012	10	1/2	14	28,5	34			15	19	
SO161214	12	1/4	11	26,5	33			14	19	
SO161238	12	3/8	11,5	25,5	34,5			15	22	
SO161212	12	1/2	14	28,5	34,5			15	22	
SO161438	14	3/8	11	26,5	39			17	22	
SO161412	14	1/2	14	30	38			17	27	
SO161512	15	1/2	14	30	38			17	27	
SO161612	16	1/2	14	31,5	39,5			19	30	
SO161812	18	1/2	14	34	44			22	32	

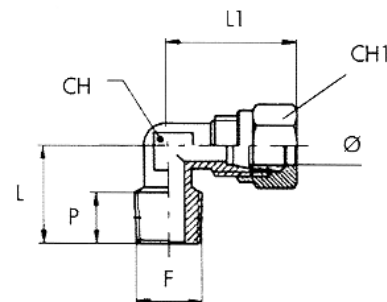

SO17 CODO INTERMEDIO



CODIGO	Ø	L	C	D	E	F	G	CH	CH1	Gr
SO170400	4	27						11	10	
SO170600	6	28						11	12	
SO170800	8	28,5						11	14	
SO171000	10	32						14	17	
SO171200	12	34,5						15	22	
SO171400	14	38						17	27	
SO171500	15	38						17	27	
SO171600	16	39,5						19	30	
SO171800	18	44						22	32	

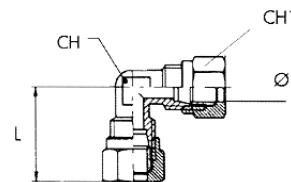

SO18 T INTERMEDIA



CODIGO	Ø	L	C	D	E	F	G	CH	CH1	Gr
SO180400	4	42						9	10	
SO180600	6	46						9	12	
SO180800	8	48						11	14	
SO181000	10	54						12	14	
SO181200	12	69						15	22	
SO181400	14	76						17	27	
SO181500	15	76						17	27	
SO181600	16	79						19	30	
SO181800	18	88						22	32	

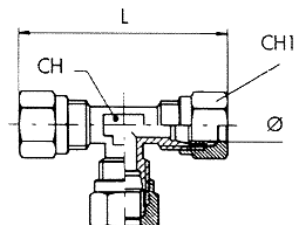

SO19 T CENTRAL CONICA MACHO



CODIGO	Ø	F	P	L	L1	F	G	CH	CH1	Gr
SO190418	4	1/8	8	16	21			9	10	
SO190618	6	1/8	8	16	23			9	12	
SO190614	6	1/4	11	20	24			11	12	
SO190818	8	1/8	8	17	24			11	14	
SO190814	8	1/4	11	20	24			11	14	
SO190838	8	3/8	11,5	24	27			13	14	
SO191014	10	1/4	11	23,5	32			13	19	
SO191038	10	3/8	11	26	21			13	17	
SO191012	10	1/2	14	28	36			17	17	
SO191214	12	1/4	11	26	34			13	19	
SO191238	12	3/8	11,5	25,5	34,5			15	22	
SO191212	12	1/2	14	28,5	34,5			15	22	
SO191412	14	1/2	14	30	38			17	27	
SO191512	15	1/2	14	30	38			17	27	
SO191612	16	1/2	14	31,5	39,5			19	30	
SO191812	18	1/2	14	34	44			22	32	

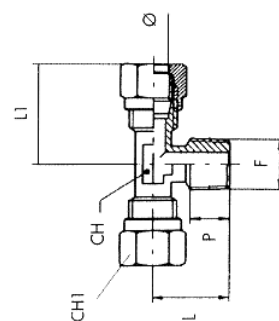

SO20 T LATERAL CONICA MACHO

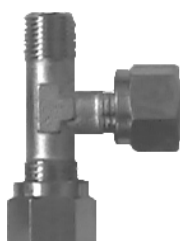

CODIGO	Ø	F	P	L	L1	F	G	CH	CH1	Gr
SO200418	4	1/8	8	37	21			9	10	
SO200618	6	1/8	8	39	23			9	10	
SO200614	6	1/4	11	44,5	24,5			11	12	
SO200818	8	1/8	8	41	24			11	14	
SO200814	8	1/4	11	44	24			11	14	
SO200838	8	3/8	11,5	51	27			13	14	
SO201014	10	1/4	11	55,5	32			13	19	
SO201038	10	3/8	11,5	56	32			13	19	
SO201012	10	1/2	14	64	36			17	17	
SO201214	12	1/4	11	60	34			13	19	
SO201238	12	3/8	11,5	60	25,5			15	22	
SO201212	12	1/2	14	63	34,5			15	22	
SO201412	14	1/2	14	68	38			17	27	
SO201512	15	1/2	14	68	38			17	27	
SO201612	16	1/2	14	71	39,5			19	30	
SO201812	18	1/2	14	78	44			22	32	

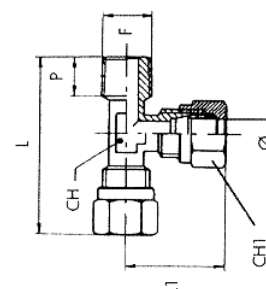

SO21 TUERCA



CODIGO	Ø	F	L	D	E	F	G	CH	CH1	Gr
SO210408	4	M8	11					10		
SO210610	6	M10	12					12		
SO210812	8	M12	13					14		
SO211016	10	M16	13					14		
SO211218	12	M18	16					22		
SO211418	14	M18	14					22		
SO211522	15	M22	-					-		
SO211624	16	M24	17,5					30		
SO211826	18	M26	18,5					32		

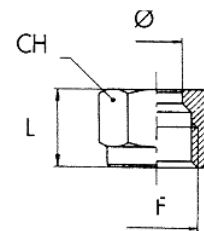

SO22 BICONO



CODIGO	Ø	L	C	D	E	F	G	CH	CH1	Gr
SO220400	4	6								
SO220500	5	7								
SO220600	6	7,5								
SO220800	8	7								
SO221000	10	7								
SO221200	12	10								
SO221400	14	10								
SO221500	15	10								
SO221600	16	10								
SO221800	18	10,5								

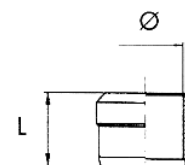

SO23 REFUERZO TUBO



CODIGO	F	D1	C	L	E	F	G	CH	CH1	Gr
SO230200	2									
SO232,500	2,5	1,7	3,5	12						
SO230400	4	3,25	5	12						
SO230600	6	5	7	15						
SO230800	8	7	9	15						
SO230900	9	8	10	15						
SO231000	10	9,5	-	14						
SO231100	11									
SO231200	12	11,5	-	16						
SO2312500	12,5	11,5	14	17						
SO231400	14	13	15	17						
SO231500	15	14	16	17						
SO231600	16	15	18	19						

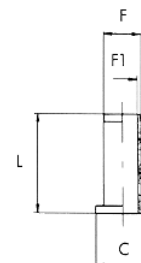

SO24 ADAPTADOR CILINDRICO MACHO



CODIGO	A	B	C	D	E	F	G	CH	CH1	Gr
SO240418	4	1/8								
SO240618	6	1/8								
SO240614	6	1/4								
SO240818	8	1/8								
SO241014	10	1/4								
SO241038	10	3/8								
SO241238	12	3/8								

Hasta fin de existencias

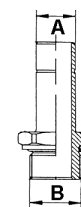

SO25 ORIENTABLE SIMPLE



CODIGO	A	B	D1	L	L1	F	G	CH	CH1	Gr
SO2504M5	4	M5	-	-	-					
SO250418	4	1/8	9,8	14,5	24,5			10		
SO250618	6	1/8	9,8	14,5	26,5			12		
SO250614	6	1/4	13,2	14,5	28,5			12		
SO250818	8	1/8	9,8	14,5	25,5			14		
SO250814	8	1/4	13,2	14,5	28			14		
SO251014	10	1/4	-	-	-			-		

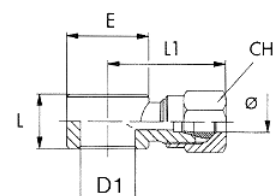

SO27 CODO HEMBRA



CODIGO	Ø	F	L	L1	P	F	G	CH	CH1	Gr
SO270418	4	1/8								
SO270618	6	1/8	20	24,5	8			9	12	
SO270614	6	1/4	25,5	27	11			13	12	
SO270818	8	1/8	20	24	8			11	14	
SO270814	8	1/4	25,5	27,5	11			13	14	
SO271014	10	1/4	27,5	31	10			14	17	
SO271012	10	1/2								

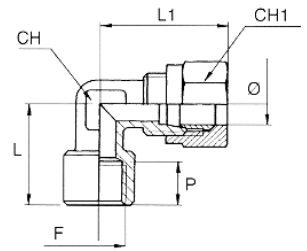

SO28 TAPON BICONO



CODIGO	Ø	L	C	D	E	F	G	CH	CH1	Gr
SO280400	4	7,5								
SO280600	6	10								
SO280800	8	9,5								
SO281000	10	9,5								
SO281200	12	9,5								
SO281400	14	9,5								
SO281500	15	10,5								

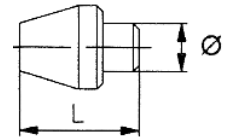

SO29 CRUZ INTERMEDIA



CODIGO	Ø	L	C	CH	CH1	Gr
SO290600	6	51		10	12	46
SO290800	8	53		10	14	59

